

SECTION-A-A

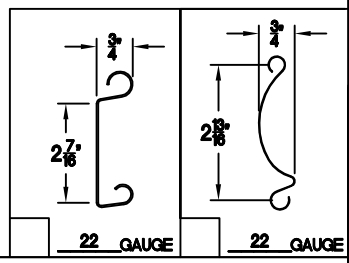

GUIDE DETAIL (NON-WINDLOCK)

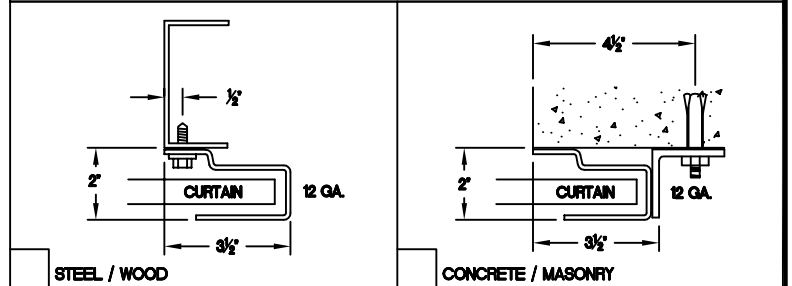

SIDEROOM REQUIREMENTS (CHOOSE TYPE OF OPERATION)			HEADROOM REQUIREMENTS (SEE ELEVATION)			
	ROPE PULL	CHAIN HOIST	MOTOR OPERATION	HEIGHT	'X'	'Y'
•A-1	6'	10'	9'	UP TO 8'-0"	20'	20'
•A-2	6'	6'	6'	UP TO 10'-0"	21'	21'
				OVER 10'-0"	23'	23'

- NOTE: ALL DOORS GREATER THAN OR EQUAL TO 14' WIDE A-1 AND A-2 - 7' MINIMUM
- NOTE: UPGRADE TO STRUCTURAL STEEL GUIDES A-1 AND A-2 - 7' MINIMUM
- NOTE: ALL DIMENSIONS ON CHART BASED ON INSIDE FACING OUT

GENERAL NOTES

- SLATS/HOOD: SELECT FINISH OPTION BELOW:
- GALVANIZED ONLY
 - GRAY POLYESTER TOP COAT
 - WHITE POLYESTER TOP COAT
- OTHER SURFACES:
- SHOP COAT BLACK PRIMER
- OPERATION:
- RIGHT HAND SHOWN, LEFT HAND OPPOSITE

MFK.	QTY.	OPENING SIZE		OPERATION	R.H.	OPTION	PROJECT:	ARCHITECT:	CONTRACTOR:	DISTRIBUTOR:	DATE:	SHEET:	OF:	BY:	REF.#	4255 McEver Industrial Dr. Acworth, GA 30101 PH:(770) 924-2600 Fax:(770) 974-1455 www.astadoor.com
		WIDTH 'W'	HEIGHT 'H'													
MODEL 322-COMMERCIAL SLAT DOOR (COMMERCIAL OPERATOR)																

Asta Door Corporation is not responsible for the use of improper installation procedures, structural supports as well as field inspection prior to manufacturing and installation.

APPROVAL SIGNATURE: _____ DATE: _____